





Turfland Avenue, Royton, Oldham, OL2 6EL

£269,950

3 1 1



- Popular Location
- Three Bedroom Semi Detached Home
- Stunning Kitchen & Bathroom
- Superb Private Garden
- Immaculate Condition
- Large Hallway
- Multi Fuel Burner
- EPC:

What a lovely house this one is. Located in this popular road is this wonderful three bedroom semi detached family home offered in amazing condition throughout. Accommodation comprising; Entrance porch, hallway, lounge and a large kitchen/dining room. To the first floor are three bedrooms and a gorgeous bathroom that needs to be seen. Accessed by a dropdown ladder is a large 20" loft room with Velux window offering multiple uses. Royton and Shaw town centers within easy reach as are local tram stops.

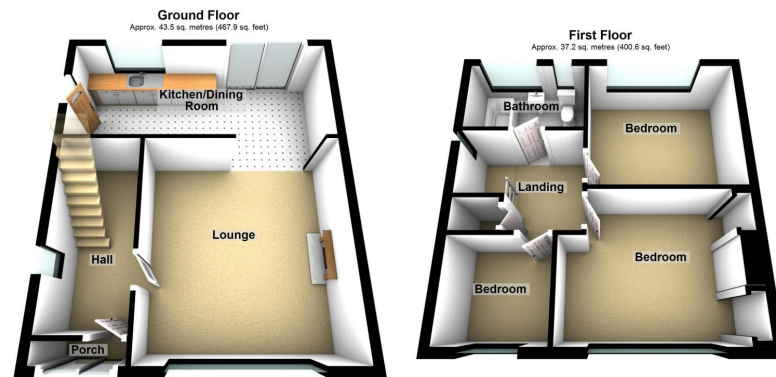

Total area: approx. 80.7 sq. metres (868.5 sq. feet)

**Royton Office**  
64 Rochdale Road,  
Royton, Oldham,  
OL2 6QJ

Monday – Friday. 9am – 5pm  
Saturday. 10am – 3 pm  
royton@kirkham-property.co.uk  
t: 0161 626 9789  
f: 0161 652 0514

Out of hours telephone service  
Monday – Thursday 8:30am – 7pm  
Friday – 8:30am – 5pm  
Saturday – Sunday 10am – 3pm

[www.kirkham-property.co.uk](http://www.kirkham-property.co.uk)